

RecDual Link User Manual

Version: 0.3.8

Release Date: February 2026

Supported Platforms: Android, Windows, iOS

Overview

RecDual Link is a configuration management application developed by **ClonerAlliance Inc.** and designed specifically for RecDual recording devices. Through direct USB connection, it provides graphical configuration of device parameters, firmware upgrades, and video file management.

1. Quick Start

1.1 Hardware Connection

1. Use a **USB-C** cable that supports data transfer to connect the RecDual device to your phone (Android) or computer (Windows).
2. **Note for Android Users:** Most phones support **Plug and Play**. If the app does not respond after connection, please search in system settings and ensure that the **OTG** or **USB Debugging** toggle is turned on.

1.2 Device Activation

First-time use requires cloud activation. The app provides different input methods based on the platform:

Mobile (Android/iOS)

- **Scan QR Code (Recommended):** Tap the "Scan QR Code to Activate" icon on the home screen and point it at the QR code on the bottom of the device or the SN code on the packaging. **After successful scanning, the app will automatically recognize and start cloud activation directly.**
- **Manual Serial Number Entry:** As an alternative to scanning. If the QR code is damaged or cannot be recognized, choose "Enter Serial Number Manually" mode, enter the **10-digit Serial Number (SN)** found on the bottom of the device, and then tap "Activate Now".



Desktop (Windows)

- **Manual Serial Number Entry:** On the computer, accurately enter the **10-digit Serial Number (SN)** from the device label and then click "Activate Now".
1. Complete verification while connected to the internet. After activation, the app will persistently remember this device's identity.
 2. **Manage Multiple Devices:**
 - A single SN supports activation on up to **5 different terminal devices** (phones or computers).
 - If you need to bind more new devices, you must first **Unbind Device** from an authorized device to free up a slot.

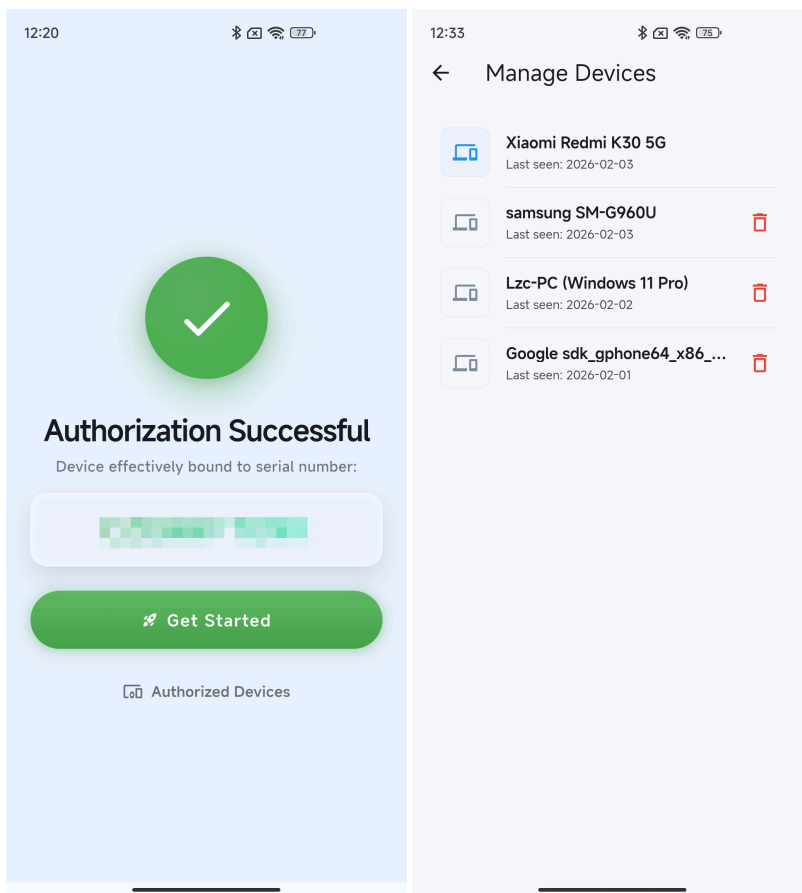

[!NOTE] Guest Mode & Authorization Cycle:

- **Guest Mode:** No activation required. If you do not enter a serial number, the app will always run in Guest Mode.
 - **Feature Restrictions:** Only basic connection status viewing is supported. You **cannot** perform video playback, **cannot** apply modified parameters, and **cannot** upgrade firmware.
- **Authorized Activation:** After entering a serial number to activate, all features will be unlocked.
 - **7-Day Offline Period:** Activated devices support up to **7 days (168 hours)** of offline use. If cloud verification is not performed again within 7 days, the app will automatically **return to Guest Mode** until the next successful internet verification.

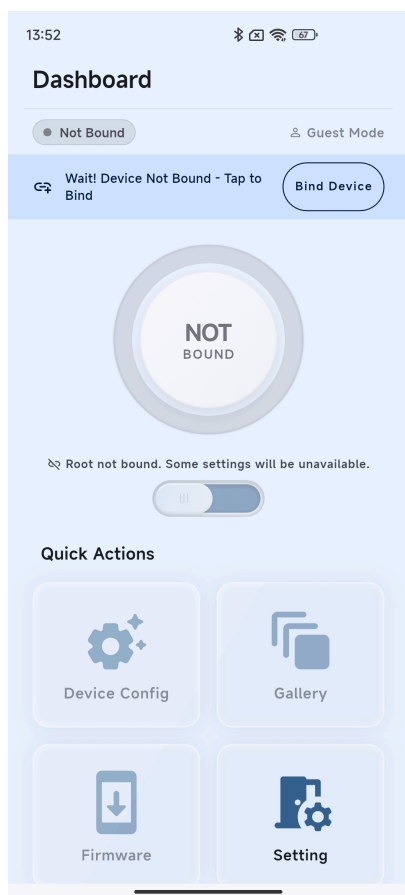

1.3 Binding Device

After activation, you need to establish a management link by authorizing a physical storage path.

1. After activation, go to the home screen. At the top, there will be a message "Bind Device". Tap this button to start the binding process.
2. **Select Path:** A system file picker will appear. Please choose according to your device and system:

Option A: Root Directory Binding (Recommended / Full Features)

- **Action:** Directly select the **Root Directory** of the recording device's drive.
- **Effect:** Unlocks all App features, including graphical configuration modification, streaming playback, and **One-click Firmware Upgrade**.

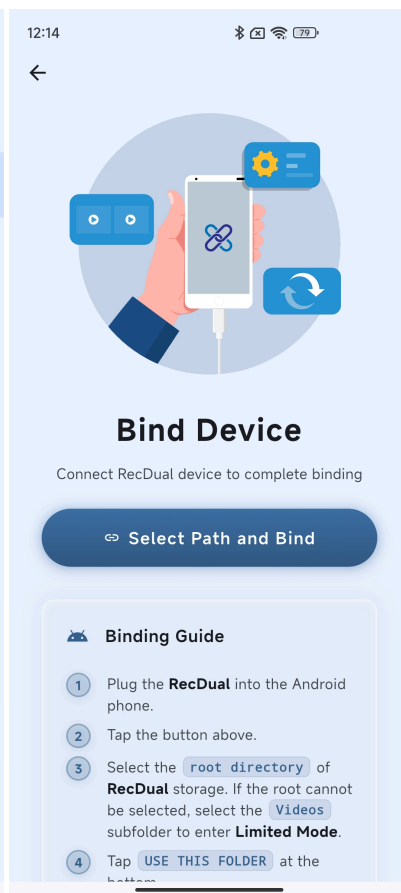
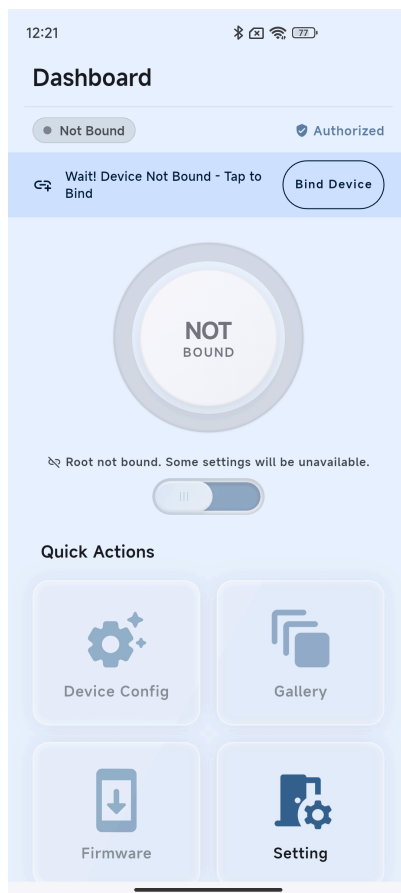

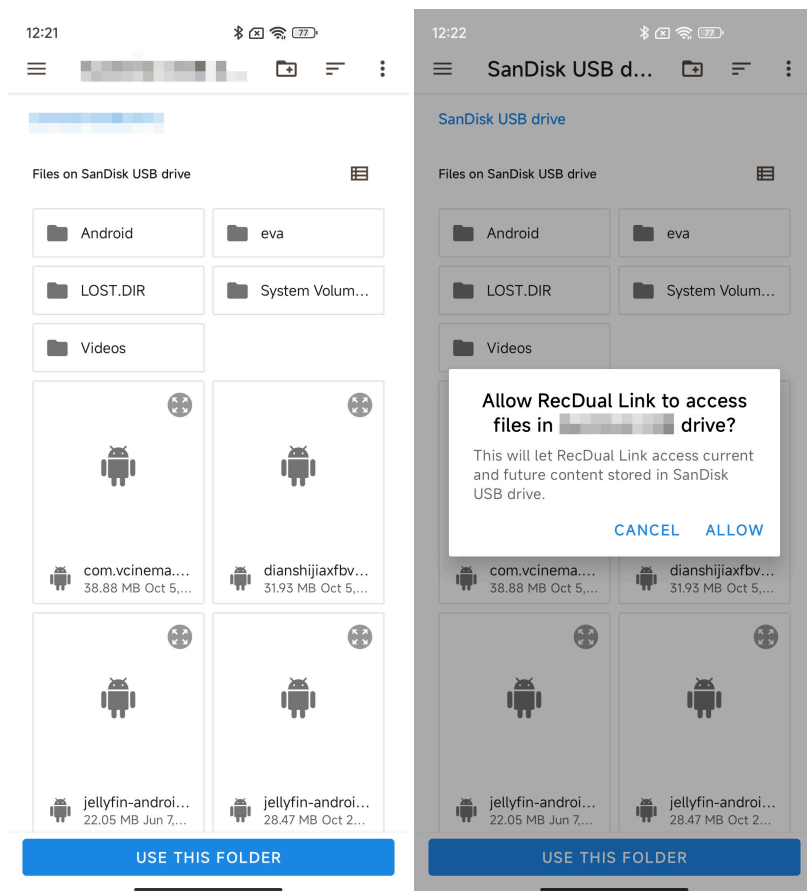

Option B: Limited Mode (Compatibility Option)

- **Background:** Some Android models may not be able to select or see the root directory of external storage.
- **Action:** If you cannot select the root directory, enter the device folder and select the **Videos** folder to authorize.
- **Effect:** The App will enter "**Limited Mode**".
 - **Feature Restrictions:** In Limited Mode, the App **cannot perform one-click firmware upgrades**.
 - **Solution:** To upgrade firmware, you can use other versions of this app on different platforms (such as the Windows version), or upgrade manually (not recommended).

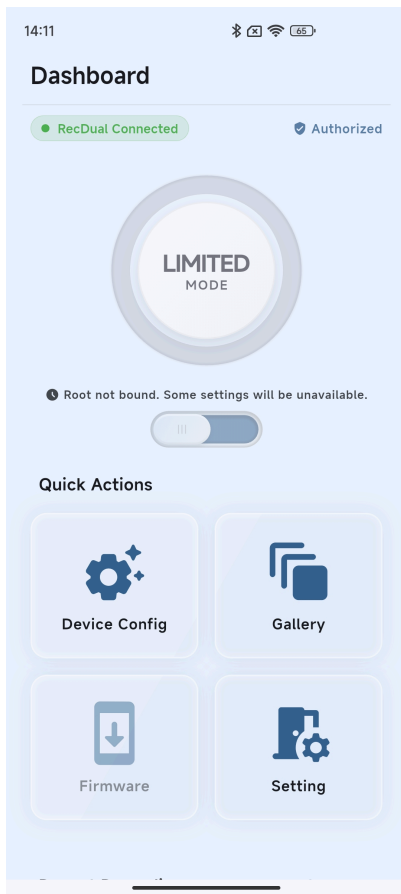

2. Core Feature Guide

2.1 Dashboard

Once activation and binding are complete, you can use the application normally. The dashboard provides a "digital mirror" of your device:

- **Storage Capacity:** Directly shows the remaining space on the TF card.
- **Intelligent Duration Estimation:** Automatically calculates the **hours/minutes** of recording time available based on current settings.
- **Display Toggle:** Tap the toggle button below the dashboard to switch between "**Remaining Recording Time**" and "**Remaining Storage Capacity**".
- **Authorization Status:** Displays the current device's licensing status.
- **Connection Status:** Real-time feedback on physical connection (● Connected / ● Disconnected).

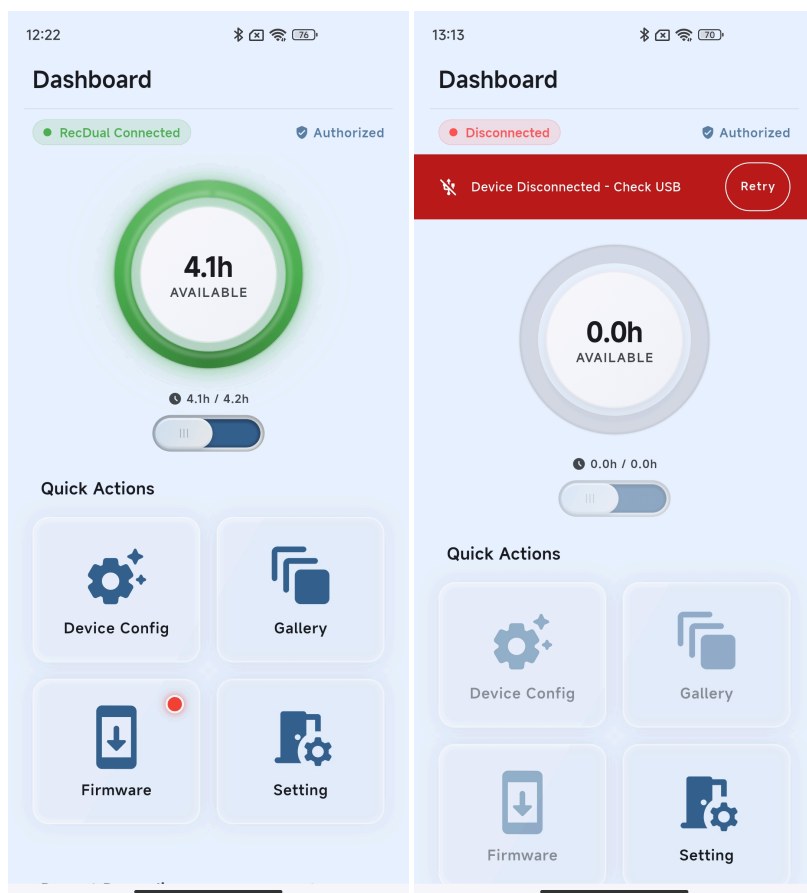

2.2 Device Configuration

No need to manually edit code files; all operations are graphical.

*[!TIP] **Automatic Config Generation:** If a brand-new TF card is inserted, as there is no content or configuration file, the app will **automatically generate configuration files using default parameters** upon first connection and binding, ensuring the device works immediately.*

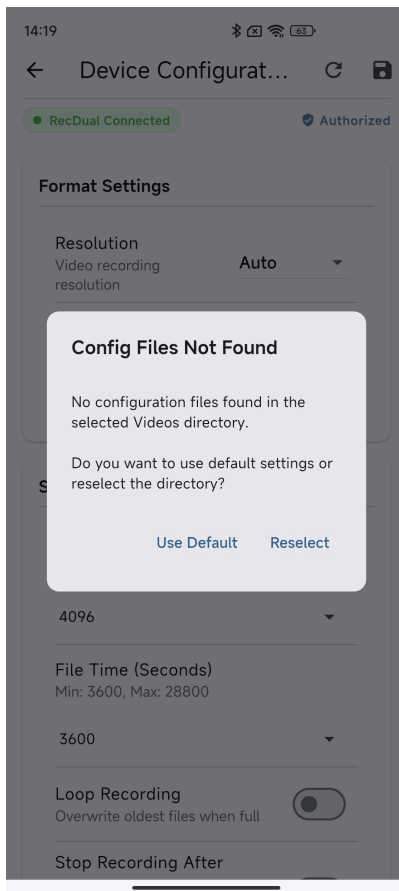

- **Recording Quality:** Adjust resolution, frame rate, and bitrate.
- **Auto Time-Sync:** When saving configuration, the device time will automatically sync with your phone/computer.
- **Advanced Options:** Configure signal loss handling, loop recording strategies, etc.

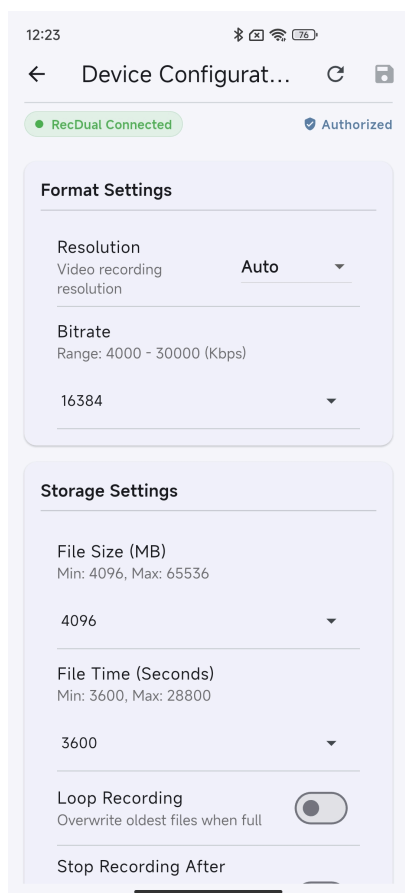

After the configuration file is saved, wait 10 seconds for it to take effect, then restart the device.

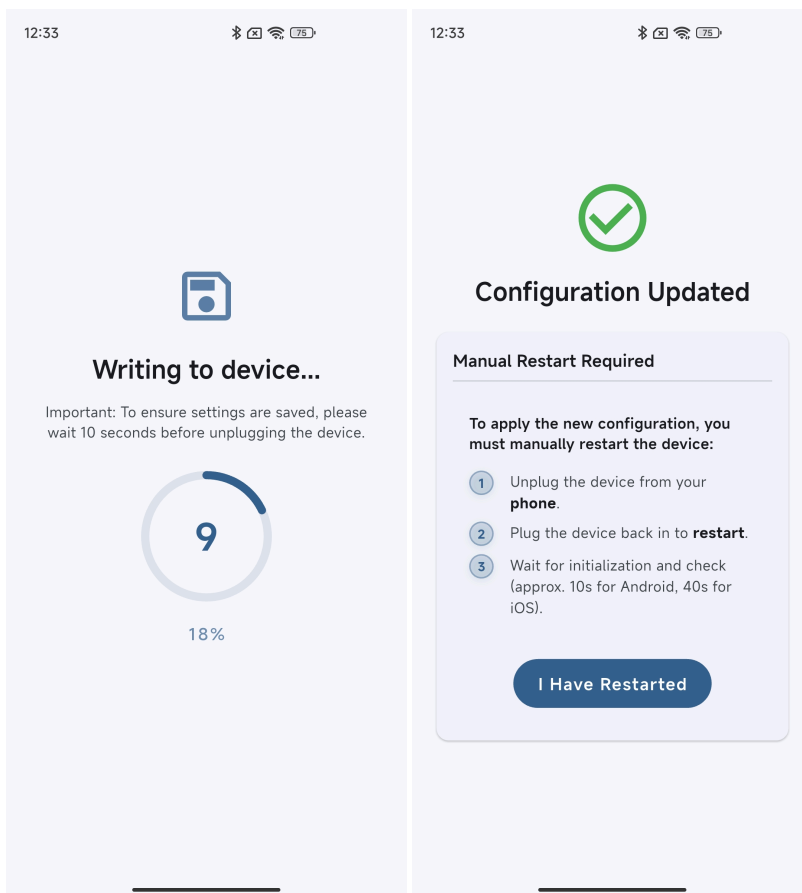

2.3 Firmware Upgrade

- **Online Detection:** A red dot on the home screen icon alerts you to a new version.
- **Manual Check:** If you don't see an automatic alert, you can enter the "Firmware Upgrade" page to manually trigger version detection.
- **One-click Upgrade:** Automatically downloads firmware and writes it to the device.
- **Safety Guarantee:** Built-in integrity checks prevent upgrade failures. Restart the device as prompted after the upgrade is complete.

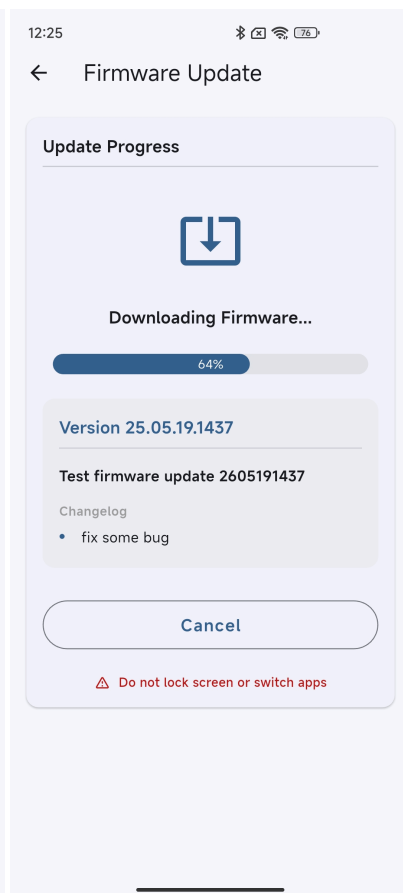
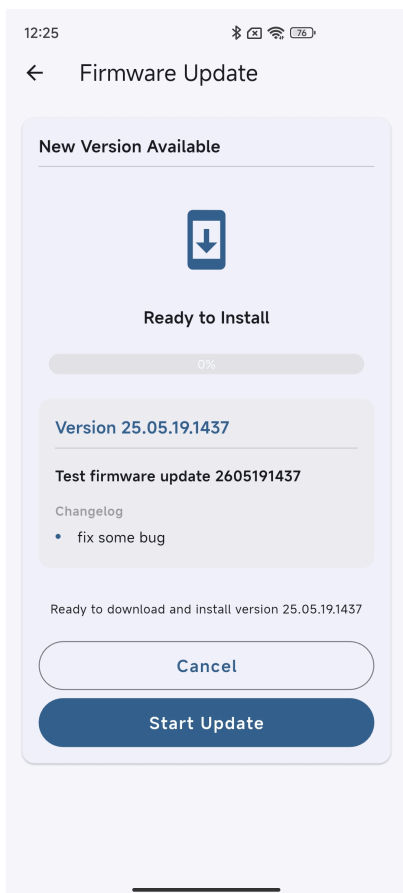

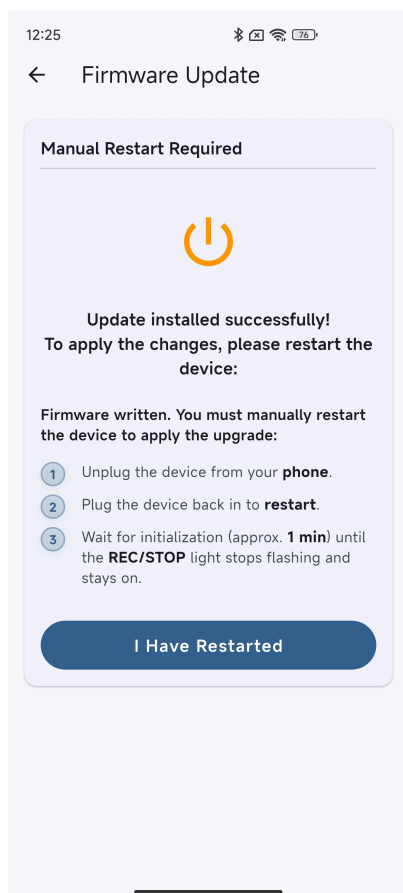

2.4 Video Playback & Management

- **Instant Playback:** Quickly scan the latest footage in the "Recent Recordings" area on the home screen.
- **File Management & Cleanup:**
 - **Multi-select Management:** Tap the "Select" button (or long-press a file) to enter management mode.
 - **Batch Operations:** Supports **Select All** and **Batch Delete** to quickly free up TF card space.
 - **Filter & Sort:** Sort videos by date, file size, or name in ascending/descending order.
- **Local Export:** Fast export of selected important videos to your mobile gallery (Android/iOS) or computer drive.

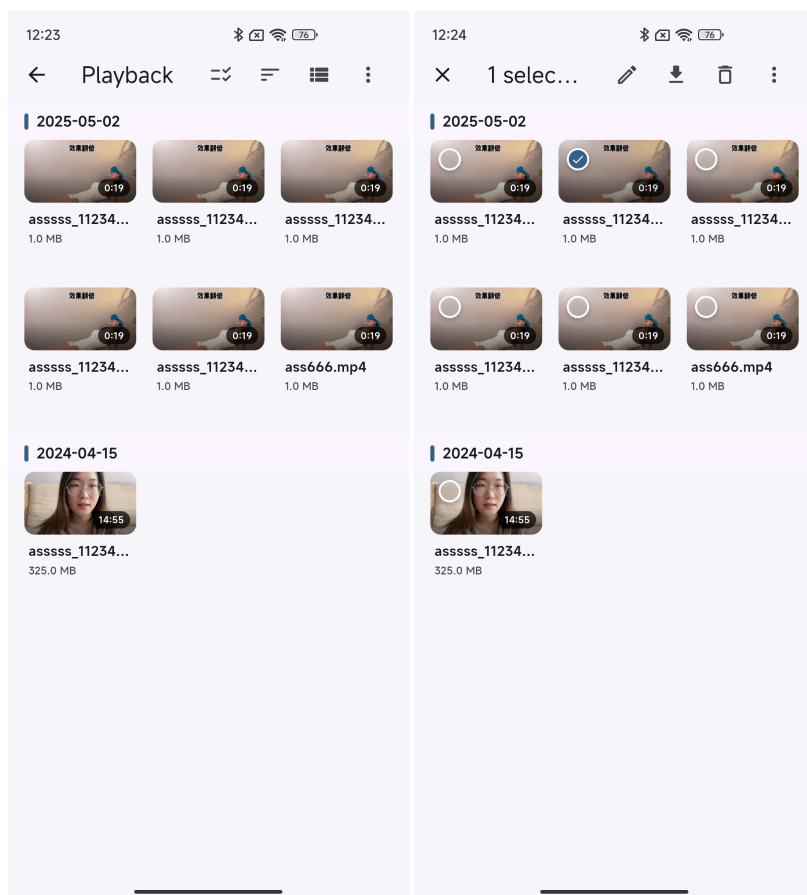

2.5 Settings & Preferences

Tap the "Settings" icon (gear) on the home screen to personalize and maintain the application:

- **Device Management:** View the list of currently bound SN authorizations and unbind devices here.
- **Appearance & Language:**
 - **App Theme:** Switch between **Light Mode**, **Dark Mode**, or **Follow System**.
 - **Multi-language Support:** Real-time switching of the app interface language (currently supports Chinese/English).
- **Account & Storage Maintenance:**
 - **Reset Binding Permissions:** If you need to change the authorized folder path (e.g., from "Limited Mode" back to "Root Mode"), tap "Reset Binding Permissions" here.
 - **Deactivate Authorization:** Removes the current device from the cloud whitelist and returns it to an unactivated state, freeing up one of your 5 authorization slots.
 - **Clear App Cache:** Completely reset the application status. **Warning:** This will clear all local configurations, login state, and serial number memory. Please confirm before proceeding.
- **About & Logs:**
 - **Check for App Updates:** Manually detect new versions of the RecDual Link app.
 - **Export/Open Logs:** When encountering technical issues, you can export log files here to send to customer support for diagnosis.

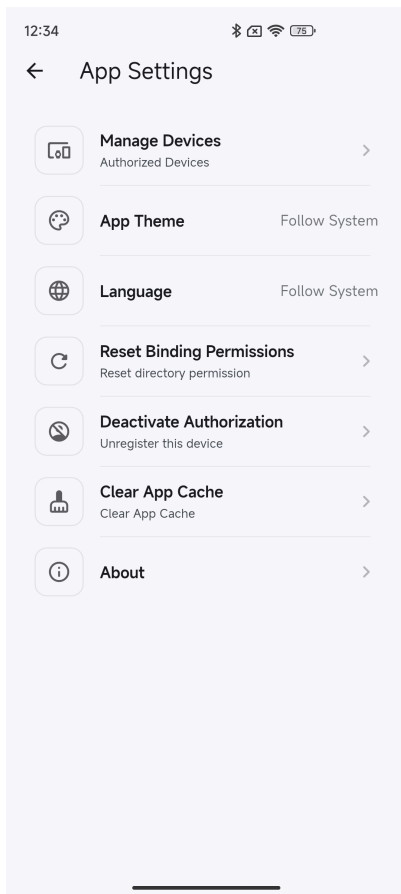

3. App Updates & Maintenance

3.1 Automatic Updates

RecDual Link supports automatic version detection to ensure you always have the latest features and security patches:

- **Windows:** When a new version is available, the app will automatically download the installer. After downloading, the system will guide you through the installation. Rest assured, your device binding status and configuration presets will be preserved.
- **Android:** Supports latest version detection and prompts users to upgrade. It is recommended to update immediately upon receiving a reminder.

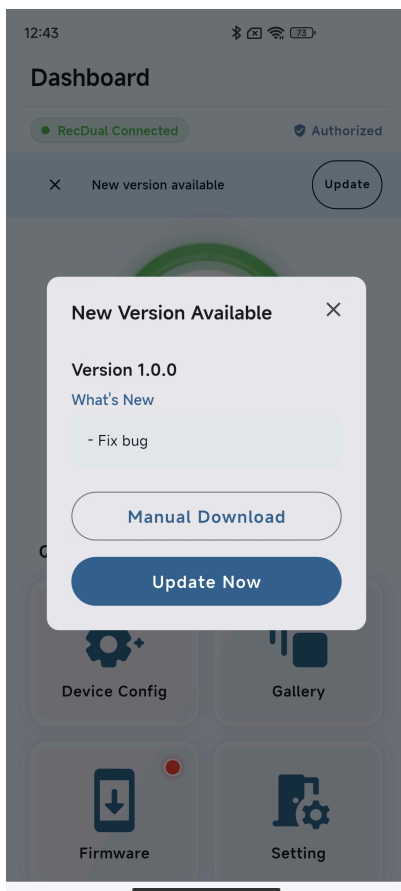

3.2 Firmware Maintenance

- **Detection Frequency:** The app automatically checks for firmware updates every 24 hours.
- **Forced Update:** For firmware containing major improvements or fixes, it is recommended to upgrade immediately to prevent device malfunctions.

4. Troubleshooting

Q: Why can't I find the device?

1. Check if the USB cable is a data cable (rather than just a charging cable).
2. Android users: Confirm OTG toggle is ON.
3. Windows users: Confirm the drive is mounted and assigned a drive letter.

Q: Why can't I upgrade the firmware? Confirm that you authorized the **Root Directory** during the "Bind Device" phase. If you are in **Limited Mode** (authorized only a subfolder), the app will not be able to write firmware files.

Q: Do I need to re-activate after updating the app? No. Activation status is stored in a secure local area. Updating the app will not cause loss of authorization.

Contact & Support

For technical support, feature requests, or bug reports, please contact our support team.

© 2026 ClonerAlliance Inc. All rights reserved.

RecDual Link is a trademark of ClonerAlliance Inc.

Document Version: 0.3.8 | Last Updated: February 2026